

**4.75 IN/120.65MM  
 TORPEDO DIA.**

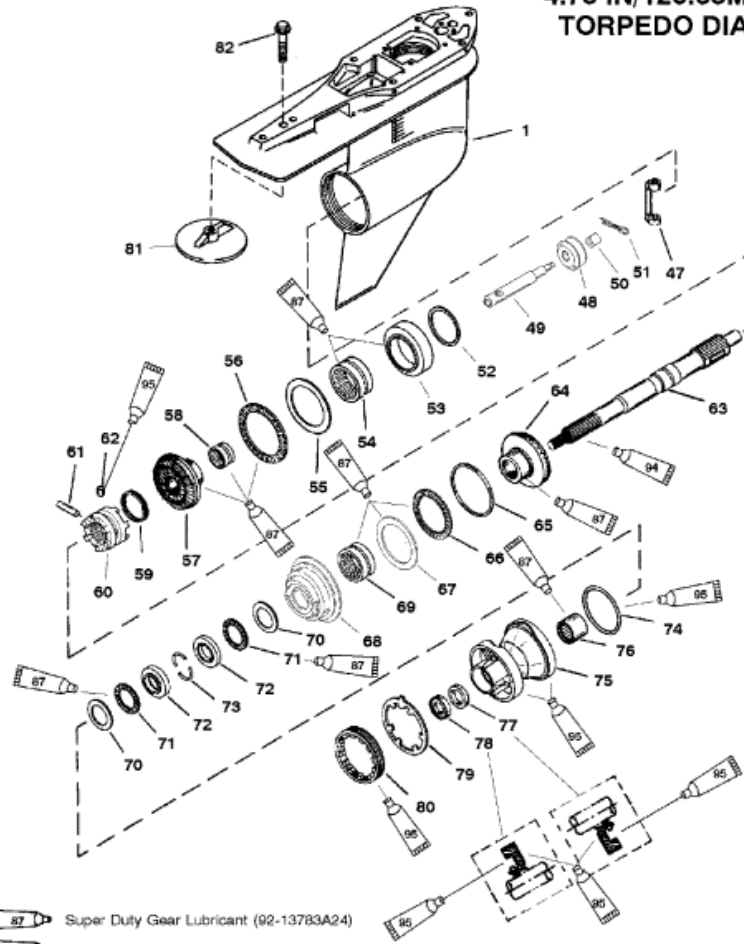

- Super Duty Gear Lubricant (92-13783A24)
- Anti-Corrosion Grease (92-78376A6)
- Loctite Quick Tite (Obtain Locally)

11095

**Parts List**

Ref	Class	Part	Description	Qty	Comment	Footnote
1	1623	822442A83	GEAR HOUSING	1	(BLACK-BASIC)	
1	1623	822442A84	GEAR HOUSING	1	(GRAY-BASIC)	
47		823903	SHIFT CRANK	1		
48		19755A 7	SPOOL ASSEMBLY	1		
49		NSS	NOT SOLD SEPARATE, Spool	1		
50		NSS	NOT SOLD SEPARATE, Sleeve	1		
51		NSS	NOT SOLD SEPARATE, Cotter F	1		
52	15	44491A 1	SHIM SET	AR		
53		828830A 2	BEARING ADAPTOR ASSEMBLY	1		
54	31	814653	BEARING ASSEMBLY, Roller	1		
55	12	815481	THRUST WASHER,	1		
56	31	815480	BEARING, Thrust	1		
57	43	828696A 2	REVERSE GEAR (1.75:1 - 12/21)	1		
58	31	15844	BEARING ASSEMBLY, Roller	1		
59	24	30893	SPRING	1		
60	52	828288	SLIDING CLUTCH	1		
61	17	30632	PIN, Cross	1		
62	17	828356	PIN, Detent	1		
63	44	824111	SHAFT, Propeller	1		
64	43	828695A 1	GEAR SET, Forward/Pinion (12/21)	1		
65	23	17615 14	SPACER SHIM, (.206)	AR		
65	23	17615 15	SPACER SHIM, (.208)	AR		
65	23	17615 16	SPACER SHIM, (.210)	AR		
65	23	17615 17	SPACER SHIM, (.212)	AR		
65	23	17615 18	SPACER SHIM, (.214)	AR		
65	23	17615 19	SPACER SHIM, (.216)	AR		
65	23	17615 20	SPACER SHIM, (.218)	AR		
65	23	17615 21	SPACER SHIM, (.220)	AR		
65	23	17615 22	SPACER SHIM, (.222)	AR		
65	23	17615 23	SPACER SHIM, (.224)	AR		
65	23	17615 24	SPACER SHIM, (.226)	AR		
65	23	17615 25	SPACER SHIM, (.228)	AR		
65	23	17615 26	SPACER SHIM, (.230)	AR		
66	31	815480	BEARING, Thrust	1		
67	12	815481	THRUST WASHER,	1		
68		828831A 1	BEARING ADAPTOR ASSEMBLY	1		
69	31	814653	BEARING ASSEMBLY, Roller	1		
70	12	18448	THRUST WASHER	2		
71	31	15842	BEARING, Thrust	2		
72		818291 1	RACE, Thrust	2		
73		814606	KEEPER	2		